

5
FUNCTION

SUPER LOW BED 3.9"

USER MANUAL



This manual must be given to the Owner/User of this bed and should be read carefully before putting this product into use. Keep manual in an accessible location for future reference.

MODEL # ULB3.9



FEATURES AND FUNCTIONS

5 FUNCTION ELECTRIC SUPER LOW BED
TRAVELS ALL THE WAY DOWN TO FLOOR LEVEL TO 3.9"
ULTIMATE FALL PREVENTION SOLUTION



ACTUATOR COVER PROTECTOR
PREVENTS DAMAGE TO MOTORS & RISK OF OPERATION FAILURE
ENSURES A SAFE ENVIRONMENT FOR PATIENT AND STAFF



TRAVEL RANGE: 3.9" - 21"
PATIENT HANDSET: 5 FUNCTION WITH TRENDLENBURG
DURABLE EASY ROLL CASTERS: 3" WITH BRAKE **MATTRESS**
RETAINERS ON EACH CORNER - INCLUDED
WEIGHT CAPACITY: 450 LBS.
MATRESSS DECK: 80" X 36"
QBAR ASSIST RAILS – SET OF 2 - OPTIONAL

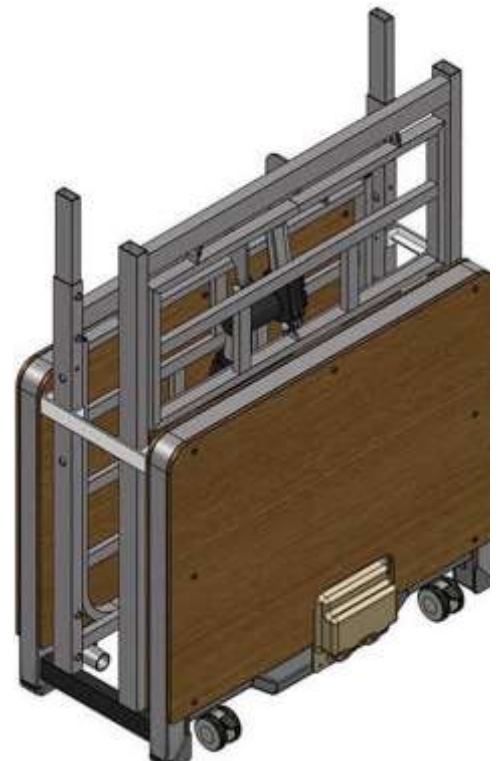

SPLIT FRAME BED DECK
EXCELLENT RENTAL SOLUTION
FOR HASSLE FREE TRANSPORT
TOTAL FOLDED DIMENSIONS:
20" W X 36" L X 48.5" H

5 Function Electric Bed Installation parts listed below as per Figure # 1:

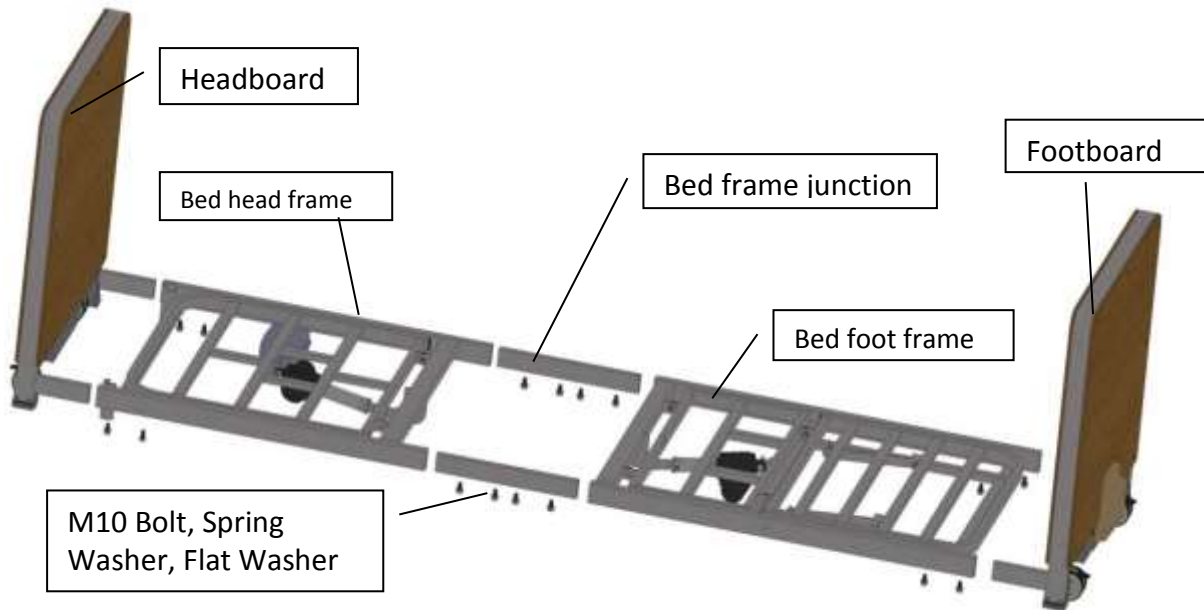

Figure # 1

The bed is foldable for easy packing and shipping as per Figure # 2

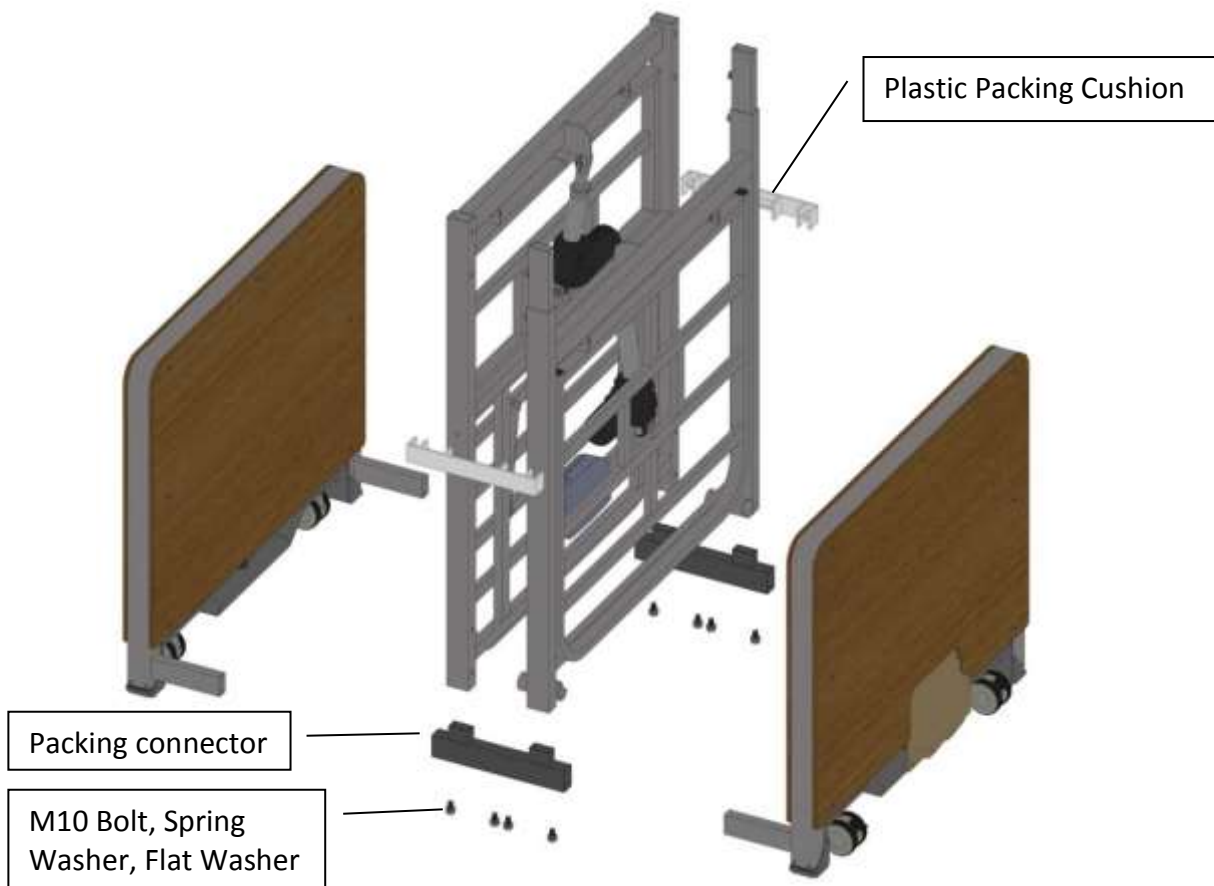

Figure # 2

1. Installing the bed frame junction block

Unscrew the M10 bolt, take out the bed frame junction block from the 50 X 30 rectangular tube. Insert the junction block (the end with threaded hole) into the 50 X 30 rectangular tube of the bed head frame, matching the bolt hole and fasten by M10 bolt with $\phi 10$ spring washer & $\phi 10$ flat washer. Do not over tighten the bolt, make sure the bed frame junction block can still move. See Figure # 3.

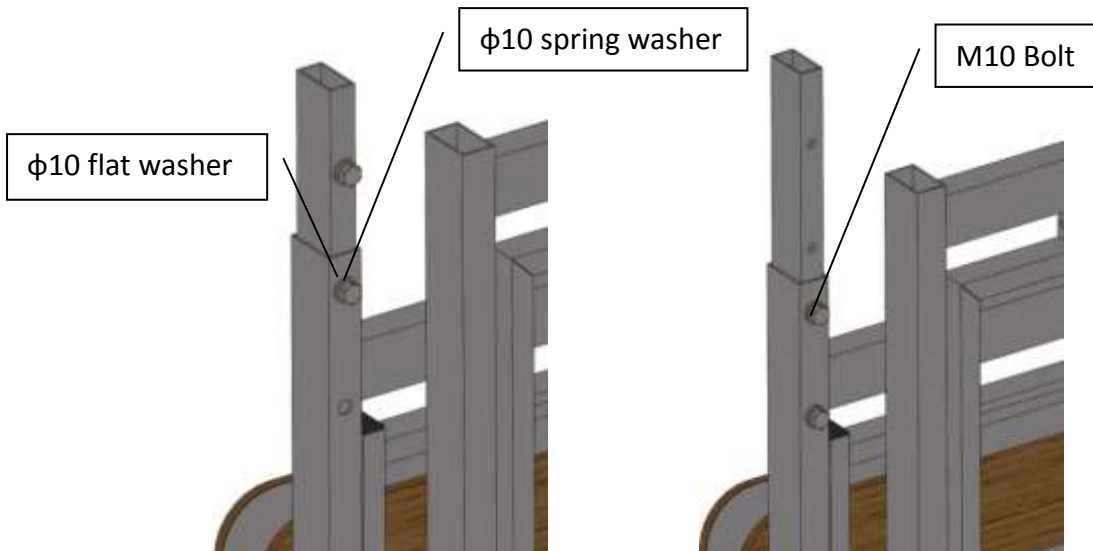

Figure # 3

2. Unfold the folded bed frames as per Figure # 4

3. Connecting the middle frame

Insert the rectangular tube of the bed foot frame directly into the bed head frame junction block, fasten with M10 bolt with $\phi 10$ spring washer & $\phi 10$ flat washer as per Figure # 4.

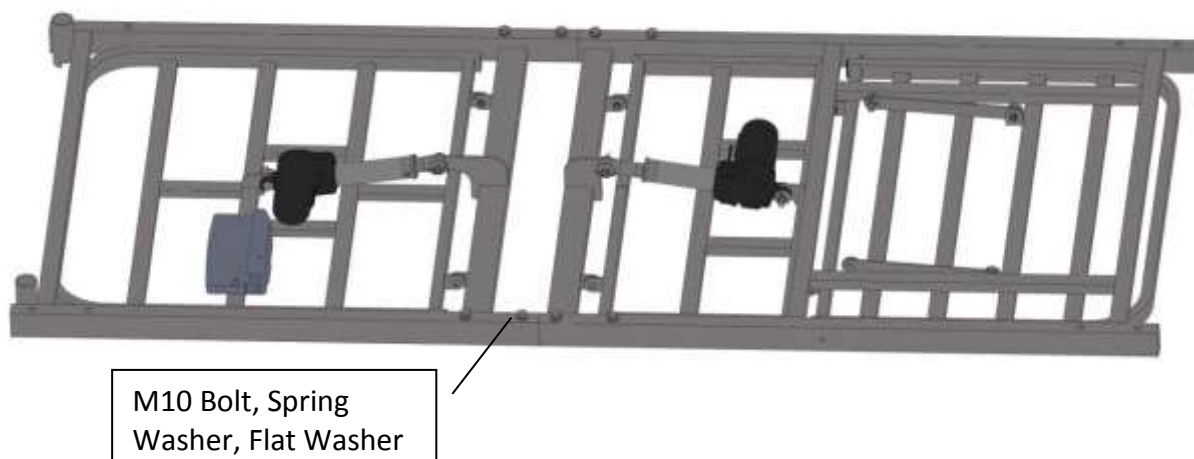

Figure # 4

4. Installing bed boards as per Figure # 5.



Figure # 5

5. Connecting motor wires
 Insert the motor wire joint into the wire connecting hole of control box as per Figure # 6.
 Put the plastic cover on as per Figure # 7

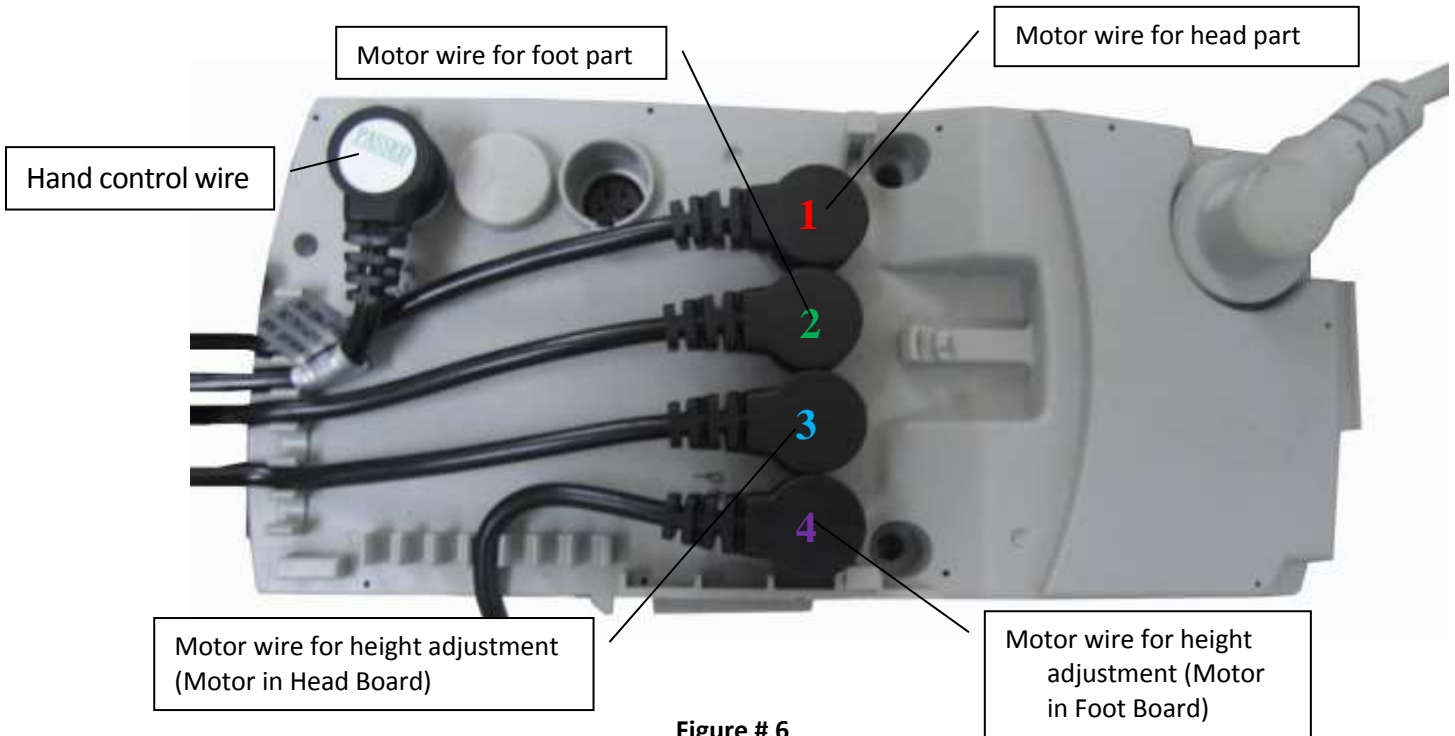

Figure # 6

MOTOR ASSEMBLY

1. HEAD
2. FOOT
3. HI/LO & TREND – AT HEAD BOARD
4. HI/LO & TREND – AT FOOT BOARD



Figure # 7

IMPORTANT: TO AVOID DAMAGE TO THE POWER CORD, PLEASE MAKE SURE TO PLACE THE POWER CORD THROUGH BOTH RINGS AS PER Figure #7A BEFORE OPERATING THE BED.



Figure # 7A

Placing the power cord through the ring as per Figure # 7B:



Figure # 7B

6. Operating the Remote Control / Hand Pendant

Ensure the power cord is connected properly. The patient can easily control all 5 functions by using the remote hand pendant. This includes adjusting the bed height, raising/lowering the head and foot sections, trendelenburg and reverse trendelenburg. Press the remote control button until the ideal position is reached. See Figure #8.

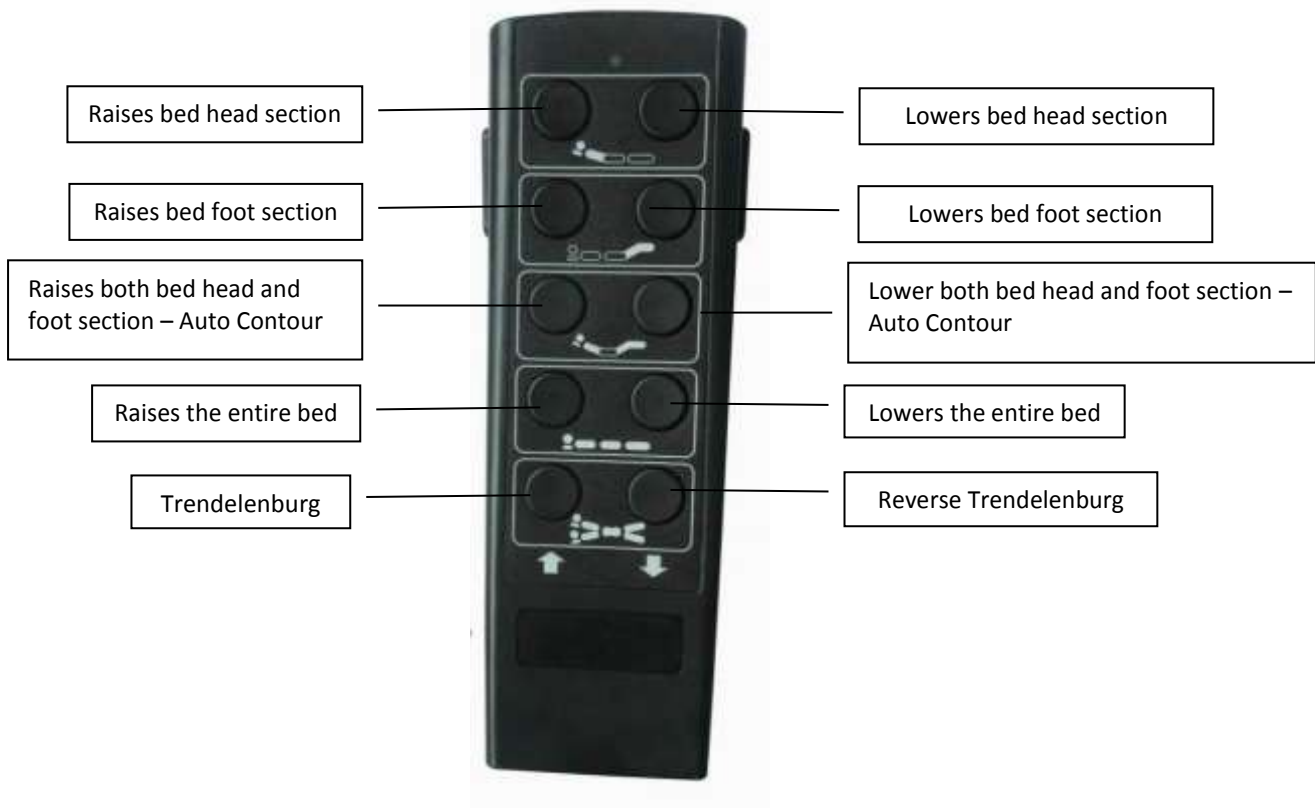

Figure # 8

7. Bumper bar Installation

Attach the bumper onto the base of the head board section as per figures # 9

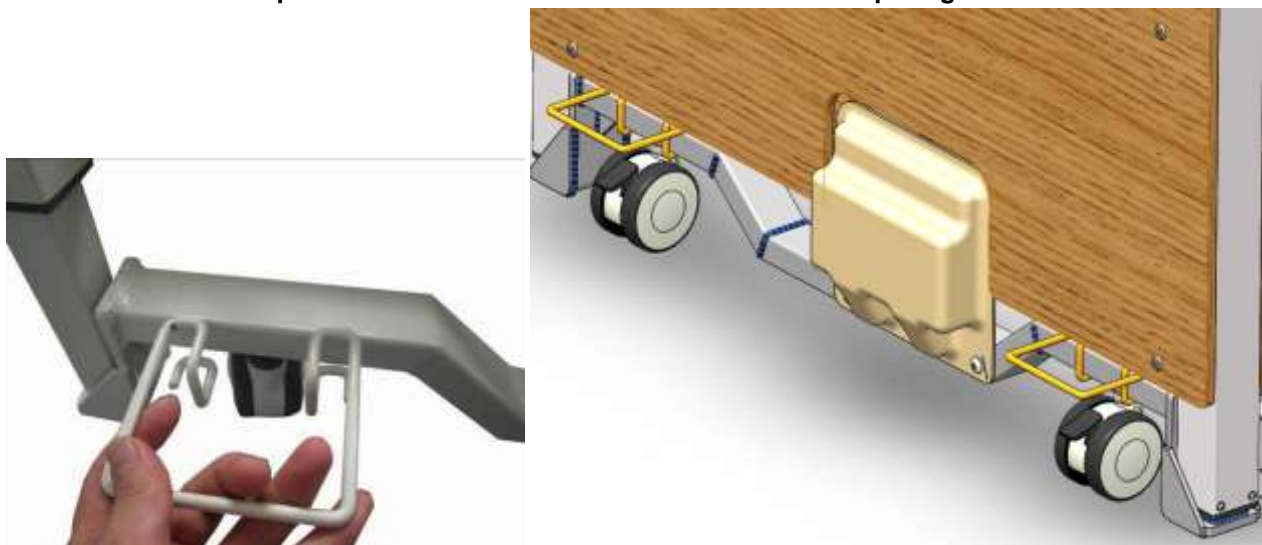

Figure 9

8. Bed Mattress Retainer Installation

Hang the Bed Mattress Retainer on the rectangular tubes of the mattress decks (see figures # 10)



Figure # 10

9. Rotating Assist Bar Installation & use

9.1.1 Insert the rail rods into the rail holes (see figures # 11).



Figure # 11

9.1.2 Secure the Rail rods to the bed by inserting the securing pins to the rod (see figures # 12).



Figure # 12

9.2. Repeat the above installation, Step 1, to install the Pivot Assist Bar on the other side.

9.3. Pivot Assist Bar is used as an assist device to help the patient transfer in and out of bed

To raise the Assist Bar: Pull up the Assist Bar until it clicks in place. See “Assist Bar raising status” in Figure # 13.

To lower the Assist Bar: Pull out the button (to unlock the Assist Bar) and push down the Assist Bar towards the head or foot section. See “Assist Bar lowering status” in Figure # 13.

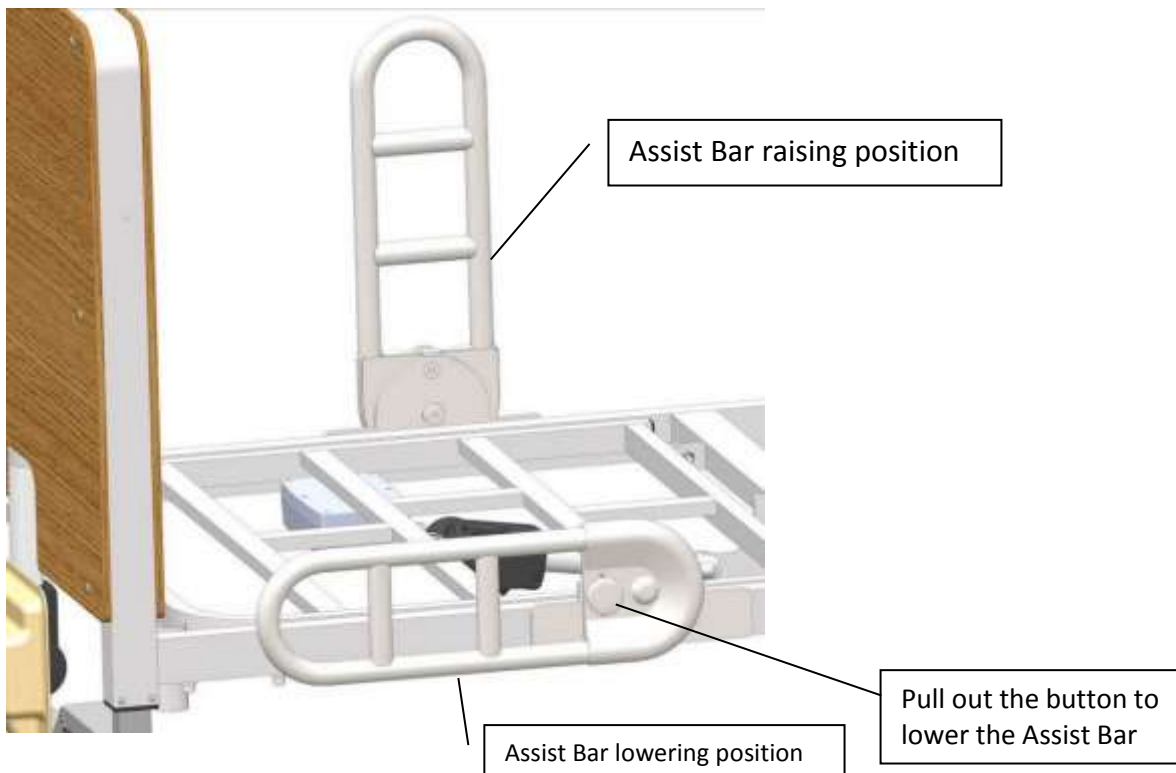

Figure # 13

Serial Number on Lower Bed Frame

When ordering parts please note bed's model and serial numbers, located on the labels under the bed deck on the lower bed frame on the length of the frame.

WARNING

Only use Medacure approved side rails with this bed. Other manufacturers assist bars and side rails may not be compatible and can lead to entrapment issues or harm to patients.

Ensure mattress is the correct size for bed frame, mattress retainers are in place and the assist bars are secured to frame to decrease the risk of entrapment.